

**THE
WEST SOMERSET DISTRICT COUNCIL
(OFF STREET PARKING PLACES)
ORDER 2015**

West Somerset Council
West Somerset House
Killick Way
Williton
Somerset
TA4 4QA
www.westsomerset.gov.uk

Page left blank

THE WEST SOMERSET DISTRICT COUNCIL (OFF STREET PARKING PLACES) ORDER 2015

PART I - GENERAL

Commencement and Citation
Definitions and Interpretations

PART II – USE OF A PARKING PLACE

General
Conditions of Use Class and Position of Vehicle
 Obstruction
 Payment for Use and Tickets
Miscellaneous Provisions

PART III - PENALTY CHARGES

Notice and Application of Penalty Charges
Restriction on Removal of Penalty Charge Notice
Manner of Payment of Penalty Charge
Representations and Appeal

PART IV - REMOVAL AND DISPOSAL OF VEHICLES

Removing or Altering the Position of a Vehicle

SCHEDULE 1 – Parking Places, Times of Operation and Daily Charges

SCHEDULE 2 – Season Ticket, Permit and Other Charges

SCHEDULE 3 – Penalty Charges

SCHEDULE 4 – Maps

THE WEST SOMERSET DISTRICT COUNCIL (OFF STREET PARKING PLACES) ORDER 2015

The West Somerset District Council (hereinafter referred to as "The Council") in exercise of their powers under Sections 35(1), (3) and (6) and 124 (and Part IV of Schedule 9) of The Road Traffic Regulation Act 1984 ("the 1984 Act") and The Traffic Management Act 2004 ("the 2004 Act") and all other enabling powers with the consent of Somerset County Council, and after consultation with the Chief Officer of Police in accordance with Section 124(1) and Schedule 9 Part III of the 1984 Act, hereby make the following Order:

PART I - GENERAL

Commencement and Citation

- 1.1 This Order shall come into operation on the first day of June 2015 and may be cited as "The West Somerset District Council (Off Street Parking Places) Order 2015".
- 1.2 The West Somerset District Council (Off-Street Parking Places) Order 1992 and all subsequent amendments thereto are hereby revoked with effect from the first day of June 2015 save and except for the contraventions committed thereunder before the date of coming into operation of this Order.
- 1.3 The West Somerset District Council (Off-Street Parking Places) Civil Enforcement Order 2012 and all subsequent amendments thereto are hereby revoked with effect from the first day of June 2015 save in respect of any contraventions committed thereunder before the date of coming into operation of this Order.
- 1.4 The West Somerset District Council (Off-Street) Parking Places (Watchet West Pier) Order 2009 and all subsequent amendments thereto are hereby revoked with effect from the first day of June 2015 save in respect of any contraventions committed thereunder before the date of coming into operation of this Order.
- 1.5 Replace The West Somerset District Council (Off-Street) Parking Places (Mart Road Coach Park, Minehead) Order 2011 and all subsequent amendments thereto are hereby revoked with effect from the first day of June 2015 save in respect of any contraventions committed thereunder before the date of coming into operation of this Order.

Definitions and Interpretation

- 2.1 In this Order except where the context otherwise requires the following expressions shall have the meanings hereby respectively assigned to them:

"Approved Device" means a device used for statutory purposes in accordance with The Civil Enforcement of Parking Contraventions (Approved Devices)(England) Order 2007.

“Blue Badge” means a disabled persons badge issued by any local authority in accordance with the provisions of The Disabled Persons (Badges for Motor Vehicles) (England) Regulations 2000 (as amended from time to time) or a badge having effect under those Regulations as if it were a disabled persons badge.

“Charge Certificate” means a notice issued to the Owner following the issue of:

- (i) a Penalty Charge Notice
- (ii) a subsequent Notice to Owner following which the Penalty Charge has not been paid.

“Charging Hours” means any time period defined in Schedule 1 to this Order in respect of which a charge is specified.

“Civil Enforcement Officer” has the same meaning as Section 76 of the 2004 Act.

“The Council” means West Somerset District Council and any statutory successor.

“Driver” in relation to a Vehicle in a Parking Place means the person driving the Vehicle at the time it was driven into and/or left in the Parking Place and for the purposes of the Order and any legal proceedings taken thereunder if on the date a Vehicle is driven into and/or left in a Parking Place a person is shown to have been the Registered Owner or keeper thereof by notification from the appropriate Registration Authority that person shall be deemed to have been the Driver of the Vehicle on that date unless the contrary is shown.

“Mobile Telephone Payment” means the purchase of a period of parking by using a mobile telephone to facilitate a cashless and ticketless parking transaction.

“Notice to Owner” means a notice issued by the enforcement authority in the event that the penalty set out in a Penalty Charge Notice has not been paid within 28 days.

“Invalid Carriage” shall mean the following Vehicles:

- (a) an Invalid Carriage as defined in Section 136 of the 1984 Act;
- (b) a specially adapted Motor Vehicle within the meaning of and exempt from Vehicle Excise Licence duty under paragraph 18 Schedule 2 of the Vehicle Excise and Registration Act 1994;
- (c) a Vehicle considered by The Council to be specially adapted for use by those with a disability.

“Owner” has the same meaning as in Section 92 of the 2004 Act.

“Penalty Charge” and “Penalty Charge Notice” have the same meaning as in regulations 2(1) and 8(1) of the Civil Enforcement of Parking Contraventions (England) General Regulations 2007.

“Parking Place” means any area of land or building specified in Schedule 1 to this Order provided by The Council under Section 32 of the 1984 Act for use as a Parking Place.

“Parking Space” means any part of the Parking Place intended for use by a Vehicle indicated by means of signs and or lines or as shown by a person authorised on that behalf by The Council.

“Permit” means any document issued or approved by The Council that allows a Vehicle to be parked in specified Parking Places, and shall include (but not exclusively): season tickets, reserved permits, tenant permits, resident or visitor permits, Councillor permits or employee permits.

“Residence” means any dwelling house or flat.

“Summer Tariff” means the charges as defined in Schedule 1 and apply within the period between 1 March and 31 October inclusive.

“The Regulations” means the regulations made from time to time by the Secretary of State pursuant to the 2004 Act.

“Trailer” means a trailer within the meaning of Section 136(1) of the 1984 Act.

“Vehicle” means (unless the context otherwise provides) any class or description of Vehicle and without prejudice to the above shall include a caravan or trailer - “heavy motor car”, “invalid carriage”, “motor car”, “motor cycle”, “motor tractor”, “heavy locomotive” and “light locomotive” have the same meaning as in Section 136 of the 1984 Act and “public service vehicle” has the same meaning as in the Public Passenger Vehicles Act 1981 and for the purpose of this Order “public service vehicles” and vehicles with 16 seats or more shall be referred to as “coaches” and “heavy motor cars”, “motor tractor”, “heavy locomotive” and “light locomotive” shall be referred to as “commercial vehicles”.

“Winter Tariff” means the charges as defined in Schedule 1 and that apply within the period between 1 November and 28/29 February inclusive.

- 2.2 The Interpretation Act 1978 as amended shall apply to the interpretation of this Order as it applies to the interpretation of an Act of Parliament as if this Order was an Act of Parliament.
- 2.3 Unless expressly stated to the contrary any references to a specific statute or regulation includes any statutory extension or modification, amendment or re-enactment of that statute or regulation and any general reference to a statute includes any regulations or orders made under that statute.

PART II - USE OF A PARKING PLACE

General

- 3.1 Each Parking Place may be used subject to the following provisions of this Order as a Parking Place for such classes of Vehicle, for such use, in such positions and on such days and during such hours and on payment of such charges as are specified in relation to that Parking Place and shall include variation thereto by virtue of a Notice made pursuant to Section 35C of the 1984 Act.
- 3.2 The Council reserves the right to temporarily suspend the use of the whole or part of any of its Parking Places, or enlarge or otherwise alter any of its Parking Places, and any associated facilities without prior notice as it deems appropriate.
- 3.3 The Council reserves the right to designate any part of any Parking Place for the exclusive use of holders of any Permit issued by The Council without prior notice as it deems appropriate.
- 3.4 Any remaining Vehicles left in a Parking Place after the notified closing time, and/or before the stated opening time, may be released on demand by a person authorised by The Council, subject to a release fee being paid by the Driver of the Vehicle.
- 3.5 No person shall use any part of any Parking Place for any purpose other than the parking of Vehicles without prior permission from The Council.

Conditions of Use

Class and Position of Vehicle

- 4.1 Where the Parking Place is described as available for Vehicles of a specified class or in a specified position, the Driver of a Vehicle shall not permit it to wait or be left in that Parking Place unless it is:
 - (a) of the specified class; and
 - (b) in a specified position being one where Parking Spaces are defined by markings on the ground or otherwise.
- 4.2 Where the Parking Place is described as available for Vehicles of a specified class (but no positions have been specified by means of markings upon the ground defining Parking Spaces) the Driver of a Vehicle:
 - (a) shall not permit it to wait or be left in a Parking Place unless it is of the specified class; and
 - (b) if of the specified class shall permit it to wait or be left only in such position or positions as may be required by a Civil Enforcement Officer or other authorised officer of The Council.
- 4.3 The Driver of a Vehicle shall not use a Parking Place which is subject to limitation or restriction on use as specified in Schedule 1 otherwise than in accordance with such limitation or restriction.

4.4 The Driver of a Vehicle shall not permit that Vehicle to wait in any Parking Place:

- (a) in a designated loading area during restricted hours unless the Vehicle is parked for the purpose of loading or unloading;
- (b) in a Parking Space where notice/markings are indicating reserved or permit holders without clearly displaying a valid Permit for the Vehicle and Parking Place in question;
- (c) in a designated restricted area;
- (d) beyond the markings of any Parking Space;
- (e) in a disabled persons Parking Space without clearly displaying a valid Blue Badge;
- (f) in a designated pick-up area unless the Vehicle is waiting for the purpose of persons boarding and alighting;
- (g) in a designated electric vehicle charging bay without charging that vehicle with electricity using the apparatus provided for that purpose.

Obstruction

5 The Driver of a Vehicle shall not, unless authorised by The Council:

- (a) use a Parking Place so as to prevent other persons from obtaining access thereto or therefrom or otherwise cause an obstruction in the Parking Place or Parking Space;
- (b) park over or beyond the Parking Space markings or otherwise use a Parking Space so as to prevent other Vehicles from using adjoining Parking Spaces;
- (c) park where cross hatching or yellow lines have been marked on the surface of the Parking Place, with the exception of Motor cycles parked in accordance with Article 6.14.

Payment for Use and Tickets

6.1 The Driver of the Vehicle shall either:

- (a) immediately upon first parking, unless otherwise instructed by a person duly authorised by The Council, in any of the Parking Places pay the appropriate charge in accordance with the scale of charges specified in Schedule 1 unless the driver is the holder of a valid Permit or the vehicle is an Invalid Carriage and displaying a valid Blue Badge; or
- (b) where a Pay on Exit or Pay on Foot facility is provided, unless otherwise instructed by a person duly authorised by The Council, in any of the Parking Places pay the appropriate charge in accordance with the scale of charges specified in Schedule 1 as directed by notices displayed in or in the immediate vicinity of the Parking Place and prior to removing the Vehicle from the Parking Place.

6.2 The charges referred to in Article 6.1 and specified in Schedule 1 shall be payable:

- (a) by the insertion of an appropriate coin or coins into the apparatus or device provided; or
- (b) where provision is made by Mobile Telephone Payment; or
- (c) by payment to an authorised person upon entry to the Parking Place, or
- (d) where provision is made for use of a Pre-paid Card, or

(e) where provision is made for use of a credit or debit card.

- 6.3 Any parking ticket issued on payment of the charge referred to in Article 6.1 will indicate either payment of the charge and the date of issue or the date and time of issue and the period running from that time during which parking is permitted. The payment indicated upon any such ticket shall be regarded as conclusive evidence as to the coinage accepted by the apparatus or device.
- 6.4 If during Charging Hours a Vehicle is left in a Parking Place and has displayed on it a parking ticket or tickets issued by a ticket issuing machine, the time indicated by the ticket issuing machine or clock on the ticket or tickets shall be evidence as to whether the period has expired for which the initial charge shown on such ticket or tickets was paid and in any proceedings for failing to pay the penalty charge shall also be evidence that a penalty charge was incurred. Where payment has been made by Mobile Telephone Payment evidence shall be provided by the Mobile Telephone Payment provider.
- 6.5 Any Permit or parking ticket or Blue Badge referred to in Article 6.1 shall be displayed on the Vehicle in respect of which it was issued being:
- (a) in the case of a Motorcycle Combination, in a conspicuous position on the Vehicle in front of the driving seat; and
 - (b) in the case of all other Vehicles:
 - (i) where the Vehicle is fitted with a transparent windscreen, facing forward on the dashboard or fascia, unless authorised differently by The Council; and
 - (ii) where the Vehicle is not fitted with a transparent windscreen, on the Vehicle in a conspicuous position so that in each case, full details printed on the face of the ticket issued, Permit or Blue Badge, are at all times visible and can clearly be read.
- 6.6 Where a charge is specified for a period, the whole of that charge shall be due and payable whether the Parking Place is used for all or part of that period.
- 6.7 The Driver of a Vehicle shall remove the Vehicle from the Parking Place before or upon the expiry of the time paid for.
- 6.8 The Driver of a Vehicle shall pay the appropriate fee for each Parking Space used or part thereof by the Vehicle.
- 6.9 The Driver of a Vehicle shall not use a Parking Place which is subject to a maximum period for parking for longer than such period. At the expiration of such maximum period the Driver shall remove the Vehicle from the Parking Place and shall not return thereto within the specified period.
- 6.10 When a Permit, parking ticket or Blue Badge has been exhibited on a Vehicle in accordance with the provisions of Article 6.5 of this Order no person shall remove the relevant ticket, Permit or badge from the Vehicle until the Vehicle has been removed from the Parking Place.

- 6.11 The Owner of a Vehicle may on prior application to The Council purchase a season ticket for a charge ascertained by reference to Schedule 2 and such a ticket shall be valid in such Parking Places as specified during the period for which it was issued.
- 6.12 Where The Council designates a Parking Place as being one where residents' permits may be used, residents of the street or streets deemed eligible may on prior application to The Council (supported by such evidential proof as The Council may reasonably require) purchase a residents' permit for a charge ascertained by reference to Schedule 2. Such residents' permit shall be valid for use in respect of the Vehicle for which it was issued in only the Parking Place specified during the period for which it was issued. No more than two residents' permits shall be issued in respect of any one Residence at any time.
- 6.13 Tickets purchased are not transferable between Vehicles and/or Parking Places unless specified.
- 6.14 Motor cycles, where permitted, may park without charge in a designated Motor cycle Parking Space and in such places so as not to cause an obstruction to other users of a Parking Place. A Motor cycle occupying a Parking Space shall pay the Motor car tariff except where otherwise specified in Schedule 1.

Miscellaneous Provisions

- 7 The Driver of a Vehicle may not enter upon, use or attempt to use a Parking Place when The Council has closed that Parking Place or has placed restrictions on use of that Parking Place and exhibited notice of such closing or restrictions on or near the Parking Place.
- 8 No part of any Parking Place may be used for the parking of a Trailer.
- 9 The Driver of a Vehicle using a Parking Place shall stop the engine as soon as the Vehicle is in position in the Parking Place and shall not start the engine except when about to change the position of the Vehicle in or to depart from the Parking Place.
- 10 No person shall without the prior written consent of The Council use a Vehicle while it is in a Parking Place in connection with the sale of or offering for sale any article to any person or persons in or near the Parking Place or in connection with the selling or offering for hire of any skill or service or for any other business or commercial purposes.
- 11 No person shall place or attach to, or cause to be placed or attached to in any Parking Place and/or any Vehicle in a Parking Place any leaflet or advertising material whatsoever without prior authorisation from The Council.
- 12 The Driver of a Vehicle shall not permit that Vehicle to be left in a Parking Place unless the Vehicle is licensed in accordance with the provisions of Section 1 of the Vehicle Excise and Registration Act 1994 and unless there is in relation to the use of the Vehicle by the Driver such a policy of insurance as complies with the requirements of Part VI of the Road Traffic Act 1988.

- 13 No person shall:
- (a) in the case of a Vehicle that is stationary in a Parking Place; or
 - (b) in the case of a Vehicle that is in motion in a Parking Place between the hours of 11.30 in the evening and 7.00 the following morning sound or cause or permit to be sounded any horn or similar instrument attached to such a Vehicle.
- 14 No person shall, except with the permission of any person duly authorised by The Council drive any Vehicle in a Parking Place other than for the purpose of leaving that Vehicle in that Parking Place in accordance with the provisions of this Order or for the purpose of departing from that Parking Place.
- 15.1 No person shall without the prior written authority of The Council use any part of a Parking Place or any Vehicle left in that Parking Place for the purposes of:
- (a) sleeping, camping or residential purposes;
 - (b) eating or cooking purposes;
 - (c) the purpose of servicing, washing, painting, constructing, maintaining or repairing or otherwise tending any Vehicle or part thereof other than is reasonably necessary to enable that Vehicle to depart from the Parking Place
 - (d) selling any object or food or drink or other comestible matter
- 15.2 Notwithstanding the provisions of Article 15.1 The Council may give consent for such activities to take place when they are provided through a written agreement with The Council for the benefit of the general public using the Parking Place.
- 16 No person shall in any Parking Place
- (a) without the consent of The Council erect or cause or permit to be erected any tent, booth, stand, building or other structure;
 - (b) place, assemble, construct or display or cause to be placed, assembled, constructed or displayed, without the previous written consent of The Council any item, matter or thing whether or not it is in, on or attached to any vehicle which shall in The Council's opinion be offensive, threatening, abusive, insulting or cause a nuisance, distress or inconvenience to any person or body;
 - (c) without the consent of The Council shall light or cause to permit to be lit any fire.
- 17 No person shall use a Parking Place as a means of passage proceeding from one road to another or to a property not owned by The Council without the express consent in writing of The Council.
- 18 Where in a Parking Place signs are erected or surface markings are laid for the purpose of:
- (a) indicating the entrance to or exit from that Parking Place; or
 - (b) indicating that a Vehicle using that Parking Place shall proceed in a specified direction within the Parking Place; or
 - (c) indicating the maximum speed limit within the Parking Place
- no person shall drive or cause or permit to be driven any Vehicle:
- (i) so that it enters that Parking Place otherwise than by an entrance or leave that Parking Place otherwise than by an exit so indicated; or

- (ii) in a direction other than specified; or
- (iii) at a speed in excess of that specified

- 19 No person shall in a Parking Place engage in pedal cycling, skateboarding, roller-skating, ball games, or games of any description unless authorised by The Council or do anything which is or may be a nuisance or annoyance to any person or to users of the Parking Place or residents of premises in the neighbourhood.
- 20 No person shall in a Parking Place
- (a) use any threatening, abusive or insulting language, gesture or conduct with intent to put any person in fear or so as to occasion a breach of the peace or whereby a breach of the peace is likely to be occasioned, or
 - (b) wantonly shout or otherwise make any loud noise to the disturbance or annoyance of users of the Parking Place or occupiers of premises in the neighbourhood; or
 - (c) deposit any waste or litter other than in the appropriate bins where provided, or
 - (d) leave or cause to be left a shopping trolley in any Parking Place or any part thereof except in a place designated for that purpose by The Council.
- 21 A person using the Parking Place shall not cause or suffer any animal belonging to him or in his charge to enter or remain in the Parking Place unless such animal continues to be under proper control and effectively restrained from causing annoyance to any person and from worrying or disturbing any other animal, continues to be under proper control and effectively confined within a Vehicle, such Vehicle is to be sufficiently ventilated as to cause no harm or distress to the animal
- 22 Vehicles owned or leased by The Council and liveried as such and used in connection with official duties are permitted to park in all Parking Places without payment.
- 23 Emergency Services Vehicles used in connection with official duties are permitted to park in all Parking Places without payment.

PART III - PENALTY CHARGES

24 Notice and Application of Penalty Charges

- 24.1 Where a contravention of Articles 4.1, 4.2, 4.3, 4.4(a), 4.4(b), 4.4(c), 4.4(e), 4.4(f), 4.4(g), 5(a), 5(c), 6.5 (insofar as it relates to Blue Badges), and 10 of the Order occurs a penalty charge at the higher level specified in column 1 of Schedule 3 shall become due and payable in respect of an offence.
- 24.2 Where a contravention of Articles 4.4(d), 5(b), 6.1(a), 6.5 (insofar as it relates to Permits and parking tickets), 6.6, 6.7, 6.8, 6.9, 7, 9, and 15.1 of the Order occurs a penalty charge at the lower level specified in column 2 of Schedule 3 shall become due and payable in respect of an offence.
- 24.3 Where a penalty charge is due a Penalty Charge Notice ("PCN") shall either;
- (a) be fixed to the Vehicle, or
 - (b) given to the person appearing to the Civil Enforcement Officer to be in charge of the Vehicle, or
 - (c) served by post on the person appearing to The Council to be the Owner of the Vehicle where the Civil Enforcement Officer attempted to serve the PCN but was prevented from doing so, or had begun to prepare a PCN but the Vehicle had been driven away, or where a contravention is recorded on an Approved Device.
- 24.4 Where a Vehicle remains in a position so as to attract a PCN a further PCN may be issued on each calendar day thereafter.

25 Restriction on Removal of Penalty Charge Notice

- 25.1 Where a PCN has been attached to a Vehicle in accordance with the provisions of Article 24.3 of this Order no person other than a Civil Enforcement Officer or some other person duly authorised by The Council or the Driver shall remove the PCN from the Vehicle whilst it remains at the Parking Place.
- 25.2 A person contravening Article 25.1 shall be guilty of an offence and liable on summary conviction to a fine not exceeding level 2 on the standard scale.

26 Manner of Payment of Penalty Charge

- 26.1 The Owner of a Vehicle in respect of which the penalty charge has been incurred shall pay the penalty charge to The Council in the manner specified in the PCN not later than by the end of the twenty eighth day beginning on the date on which the PCN was served.
- 26.2 If the penalty charge is paid before the expiry of the fourteenth day beginning on the date the PCN was issued the penalty charge in respect of contraventions of Articles 4.1 to 4.4(c), 4.4(e), 4.4(f), 4.4(g), 5(a), 5(c), 6.5, and 10 shall be reduced to the sum specified in column 3 of Schedule 3 and for contraventions of Articles 4.4(d), 5(b), 6.1(a), 6.5, 6.6 to 6.9, 7, 9 and 15.1 shall be reduced to the sum specified in column 4 of Schedule 3.

26.3 If the penalty charge is not paid within 28 days of the PCN being served a Notice to Owner may be served.

26.4 If the penalty charge is not paid:

- (a) within 28 days following:
 - (i) service of a Notice to Owner when no representation have been made to such a notice, or
 - (ii) service of a notice of rejection of representation made by the Owner where no appeal of the notice of rejection has been made, or
 - (iii) service of notification by The Council to the Owner that the Council does not accept any recommendation of the adjudicator to cancel the Notice to the Owner, or
 - (iv) service of a notice by the appeals adjudicator of his decision relating to an unsuccessful appeal,

WHICH EVER IS THE EARLIEST
OR

- (b) within 14 days of the Owner withdrawing his appeal to an adjudicator against a notice of rejection before the adjudicator serves notice of his decision

then the Council may then serve a Charge Certificate on the Owner to the effect that the penalty charge is increased in respect of contravention of Articles 4.1 to 4.4(c), 4.4(e), 4.4(f), 4.4(g), 5(a), 5(c), 6.5, and 10 to the sum specified in column 5 of Schedule 3 and in respect of contraventions of Articles 4.4(d), 5(b), 6.1(a), 6.5, 6.6 to 6.9, 7, 9 and 15.1 to the sum specified in column 6 of Schedule 3.

Representations and Appeal

27 The Regulations shall apply in relation to this Order in respect of the making and determination of representations and appeals.

PART IV - REMOVAL AND DISPOSAL OF VEHICLES

28 Removing or Altering the Position of a Vehicle

28.1 A Civil Enforcement Officer or a person authorised by The Council or a Police Officer in uniform may alter or cause to be altered the position of a Vehicle or trailer (as defined in Section 136(1) of the 1984 Act) in a Parking Place or remove or arrange for the removal of a Vehicle or trailer from a Parking Place:

- (a) for the purpose of meeting the requirement of an emergency; or
- (b) where the Vehicle is subject of three or more contraventions of this Order and the PCNs remain unpaid; or
- (c) where the Vehicle or trailer is creating a hazard or an obstruction or appears to The Council to have been abandoned within the Parking Place for a period in excess of 7 days.

28.2 Any person removing or altering the position of a Vehicle or trailer by virtue of Article 28.1 may do so by towing or driving the Vehicle or trailer or in such other manner as he/she may think necessary and may take such measure or measures in relation to the Vehicle or trailer as he/she may deem necessary to enable him to remove it or alter its position as the case may be.

28.3 When a person authorised by The Council removes or makes arrangements for the removal of a Vehicle or trailer from a Parking Place by virtue of Article 28.1 he/she shall make such arrangements as may be reasonably necessary for the safe custody of the Vehicle or trailer.

28.4 Neither The Council nor any person authorised on its behalf shall be liable for any damage caused or inflicted or any costs, damages, expenses or disbursements incurred by any person in respect of their property as a result of any action that may be taken in accordance with Articles 28.1 and 28.2 of this Order.

28.5 Any costs associated with the removal and storage of Vehicles or trailers shall be payable by the Owner within 28 days of demand issued by The Council.

Dated this twenty ninth day of May 2015

The **Common Seal** of **West Somerset District Council** was hereunto affixed in the presence of:-

)
)



Authorised Signatory

THE WEST SOMERSET DISTRICT COUNCIL (OFF STREET PARKING PLACES) ORDER 2015
SCHEDULE 1 –PARKING PLACES, TIMES OF OPERATION AND DAILY CHARGES

(1) Name of Parking Place	(2) Classes of Vehicle	(3) Position in which vehicle may wait	(4) Days and Hours of operation of Parking Place	(5) Charging Hours	(6) Winter Tariff Charges (between 1 November and 28/29 February)	(7) Summer Charges (between 1 March and 31 October)
Quaywest Car Park (Minehead)	(i) Motor cars within the provisions of Section 136 (2) (a) of the Act of 1984 (ii) Motor cycles as defined in Section 136 (4) of the Act of 1984 (iii) Motor vehicles constructed or adapted for use for the conveyance of goods or burden the unladen weight of which does not exceed 30 cwt.	Wholly within a Parking Space except a Parking Space marked as being reserved for vehicles displaying a Blue Badge or any other Permit issued or approved by the Council	All Days All Hours	Between 09.00 – 18.00 Mondays to Sundays (including Bank or Public Holidays)	Up to 1 hour £1.50 Up to 2 hours £2.60 Up to 4 hours £4.20 All day £5.70	Up to 1 hour £1.50 Up to 2 hours £2.80 Up to 4 hours £4.40 All day £5.90
	(iv) Vehicles displaying in the relevant position a disabled person's badge	Wholly within a Parking Space except a Parking Space marked as being reserved for vehicles displaying a Permit issued or approved by the Council	All Days All Hours	Between 09.00 – 18.00 Mondays to Sundays (including Bank or Public Holidays)	Maximum stay 3 hours, no return within 1 hour No Charge	Maximum stay 3 hours, no return within 1 hour No Charge

(1) Name of Parking Place	(2) Classes of Vehicle	(3) Position in which vehicle may wait	(4) Days and Hours of operation of Parking Place	(5) Charging Hours	(6) Winter Tariff Charges (between 1 November and 28/29 February)	(7) Summer Charges (between 1 March and 31 October)
Warren Road Upper (Minehead)	(i) Motor cars within the provisions of Section 136 (2) (a) of the Act of 1984 (ii) Motor cycles as defined in Section 136 (4) of the Act of 1984 (iii) Motor vehicles constructed or adapted for use for the conveyance of goods or burden the unladen weight of which does not exceed 30 cwt.	Wholly within a Parking Space except a Parking Space marked as being reserved for vehicles displaying a Blue Badge or any other Permit issued or approved by the Council	All Days All Hours	Between 09.00 – 18.00 Mondays to Sundays (including Bank or Public Holidays)	Up to 1 hour £1.50 Up to 2 hours £2.60 Up to 4 hours £4.20 All day £5.70	Up to 1 hour £1.50 Up to 2 hours £2.80 Up to 4 hours £4.40 All day £5.90
	(iv) Vehicles displaying in the relevant position a disabled person's badge				Maximum stay 3 hours, no return within 1 hour No Charge	Maximum stay 3 hours, no return within 1 hour No Charge
Clanville (Minehead)	(i) Motor cars within the provisions of Section 136 (2) (a) of the Act of 1984 (ii) Motor cycles as defined in Section 136 (4) of the Act of 1984 (iii) Motor vehicles constructed or adapted for use for the conveyance of goods or burden the unladen weight of which does not exceed 30 cwt.	Wholly within a Parking Space except a Parking Space marked as being reserved for vehicles displaying a Blue Badge or any other Permit issued or approved by the Council	All Days All Hours	Between 09.00 – 18.00 Mondays to Sundays (including Bank or Public Holidays)	Up to 2 hours £1.60 All day £4.20	Up to 2 hours £2.20 All day £4.90

(1) Name of Parking Place	(2) Classes of Vehicle	(3) Position in which vehicle may wait	(4) Days and Hours of operation of Parking Place	(5) Charging Hours	(6) Winter Tariff Charges (between 1 November and 28/29 February)	(7) Summer Charges (between 1 March and 31 October)
	(iv) Vehicles displaying in the relevant position a disabled person's badge	Wholly within a Parking Space except a Parking Space marked as being reserved for vehicles displaying a Permit issued or approved by the Council	All Days All Hours	Between 09.00 – 18.00 Mondays to Sundays (including Bank or Public Holidays)	Maximum stay 3 hours, no return within 1 hour No Charge	Maximum stay 3 hours, no return within 1 hour No Charge
Alexandra Road (Minehead)	(i) Motor cars within the provisions of Section 136 (2) (a) of the Act of 1984 (ii) Motor cycles as defined in Section 136 (4) of the Act of 1984 (iii) Motor vehicles constructed or adapted for use for the conveyance of goods or burden the unladen weight of which does not exceed 30 cwt.	Wholly within a Parking Space except a Parking Space marked as being reserved for vehicles displaying a Blue Badge or any other Permit issued or approved by the Council	All Days All Hours	Between 09.00 – 18.00 Mondays to Sundays (including Bank or Public Holidays)	Up to 1 hour £0.80 Up to 2 hours £1.50 Up to 4 hours £2.50 All day £4.70	Up to 1 hour £1.00 Up to 2 hours £2.20 Up to 4 hours £2.70 All day £4.90
	(iv) Vehicles displaying in the relevant position a disabled person's badge	Wholly within a Parking Space except a Parking Space marked as being reserved for vehicles displaying a Permit issued or approved by the Council	All Days All Hours	Between 09.00 – 18.00 Mondays to Sundays (including Bank or Public Holidays)	Maximum stay 3 hours, no return within 1 hour No Charge	Maximum stay 3 hours, no return within 1 hour No Charge

(1) Name of Parking Place	(2) Classes of Vehicle	(3) Position in which vehicle may wait	(4) Days and Hours of operation of Parking Place	(5) Charging Hours	(6) Winter Tariff Charges (between 1 November and 28/29 February)	(7) Summer Charges (between 1 March and 31 October)
Summerland (Minehead)	(i) Motor cars within the provisions of Section 136 (2) (a) of the Act of 1984 (ii) Motor cycles as defined in Section 136 (4) of the Act of 1984 (iii) Motor vehicles constructed or adapted for use for the conveyance of goods or burden the unladen weight of which does not exceed 30 cwt.	Wholly within a Parking Space except a Parking Space marked as being reserved for vehicles displaying a Blue Badge or any other Permit issued or approved by the Council	All Days All Hours	Between 09.00 – 18.00 Mondays to Sundays (including Bank or Public Holidays)	Up to 2 hour £1.00	Up to 2 hour £1.00
	(iv) Vehicles displaying in the relevant position a disabled person's badge				Maximum stay 3 hours, no return within 1 hour No Charge	Maximum stay 3 hours, no return within 1 hour No Charge
North Road (Minehead)	(i) Motor cars within the provisions of Section 136 (2) (a) of the Act of 1984 (ii) Motor cycles as defined in Section 136 (4) of the Act of 1984 (iii) Motor vehicles constructed or adapted for use for the conveyance of goods or burden the unladen weight of which does not exceed 30 cwt.	Wholly within a Parking Space except a Parking Space marked as being reserved for vehicles displaying a Blue Badge or any other Permit issued or approved by the Council	All Days All Hours	Between 09.00 – 18.00 Mondays to Sundays (including Bank or Public Holidays)	Up to 1 hour £1.40 Up to 2 hours £2.00 Up to 4 hours £2.80 All day £4.70	Up to 1 hour £1.50 Up to 2 hours £2.20 Up to 4 hours £2.70 All day £4.90

(1) Name of Parking Place	(2) Classes of Vehicle	(3) Position in which vehicle may wait	(4) Days and Hours of operation of Parking Place	(5) Charging Hours	(6) Winter Tariff Charges (between 1 November and 28/29 February)	(7) Summer Charges (between 1 March and 31 October)
	(iv) Vehicles displaying in the relevant position a disabled person's badge	Wholly within a Parking Space except a Parking Space marked as being reserved for vehicles displaying a Permit issued or approved by the Council	All Days All Hours	Between 09.00 – 18.00 Mondays to Sundays (including Bank or Public Holidays)	Maximum stay 3 hours, no return within 1 hour No Charge	Maximum stay 3 hours, no return within 1 hour No Charge
Porlock Central (Porlock)	(i) Motor cars within the provisions of Section 136 (2) (a) of the Act of 1984 (ii) Motor cycles as defined in Section 136 (4) of the Act of 1984 (iii) Motor vehicles constructed or adapted for use for the conveyance of goods or burden the unladen weight of which does not exceed 30 cwt.	Wholly within a Parking Space except a Parking Space marked as being reserved for vehicles displaying a Blue Badge or any other Permit issued or approved by the Council	All Days All Hours	Between 09.00 – 18.00 Mondays to Sundays (including Bank or Public Holidays)	Up to 1 hour £0.80 Up to 2 hours £1.50 Up to 4 hours £2.50 All day £4.70	Up to 1 hour £1.00 Up to 2 hours £1.70 Up to 4 hours £2.70 All day £4.90
	(iv) Vehicles displaying in the relevant position a disabled person's badge	Wholly within a Parking Space except a Parking Space marked as being reserved for vehicles displaying a Permit issued or approved by the Council	All Days All Hours	Between 09.00 – 18.00 Mondays to Sundays (including Bank or Public Holidays)	Maximum stay 3 hours, no return within 1 hour No Charge	Maximum stay 3 hours, no return within 1 hour No Charge

(1) Name of Parking Place	(2) Classes of Vehicle	(3) Position in which vehicle may wait	(4) Days and Hours of operation of Parking Place	(5) Charging Hours	(6) Winter Tariff Charges (between 1 November and 28/29 February)	(7) Summer Charges (between 1 March and 31 October)
Doverhay (Porlock)	(i) Motor cars within the provisions of Section 136 (2) (a) of the Act of 1984 (ii) Motor cycles as defined in Section 136 (4) of the Act of 1984 (iii) Motor vehicles constructed or adapted for use for the conveyance of goods or burden the unladen weight of which does not exceed 30 cwt.	Wholly within a Parking Space except a Parking Space marked as being reserved for vehicles displaying a Blue Badge or any other Permit issued or approved by the Council	All Days All Hours	Between 09.00 – 18.00 Mondays to Sundays (including Bank or Public Holidays)	Maximum stay 2 hours, no return within 1 hour Up to 1 hour £0.80 Up to 2 hours £1.50	Maximum stay 2 hours, no return within 1 hour Up to 1 hour £1.00 Up to 2 hours £1.70
	(iv) Vehicles displaying in the relevant position a disabled person's badge				Maximum stay 3 hours, no return within 1 hour No Charge	Maximum stay 3 hours, no return within 1 hour No Charge
Dunster Steep (Dunster)	(i) Motor cars within the provisions of Section 136 (2) (a) of the Act of 1984 (ii) Motor cycles as defined in Section 136 (4) of the Act of 1984 (iii) Motor vehicles constructed or adapted for use for the conveyance of goods or burden the unladen weight of which does not exceed 30 cwt.	Wholly within a Parking Space except a Parking Space marked as being reserved for vehicles displaying a Blue Badge or any other Permit issued or approved by the Council	All Days All Hours	Between 09.00 – 18.00 Mondays to Sundays (including Bank or Public Holidays)	Up to 2 hour £1.50 Up to 4 hours £2.50 All Day £4.70	Up to 2 hour £1.70 Up to 4 hours £2.70 All Day £4.90

(1) Name of Parking Place	(2) Classes of Vehicle	(3) Position in which vehicle may wait	(4) Days and Hours of operation of Parking Place	(5) Charging Hours	(6) Winter Tariff Charges (between 1 November and 28/29 February)	(7) Summer Charges (between 1 March and 31 October)
	(iv) Vehicles displaying in the relevant position a disabled person's badge	Wholly within a Parking Space except a Parking Space marked as being reserved for vehicles displaying a Permit issued or approved by the Council	All Days All Hours	Between 09.00 – 18.00 Mondays to Sundays (including Bank or Public Holidays)	Maximum stay 3 hours, no return within 1 hour No Charge	Maximum stay 3 hours, no return within 1 hour No Charge
Park Street (Dunster)	(i) Motor cars within the provisions of Section 136 (2) (a) of the Act of 1984 (ii) Motor cycles as defined in Section 136 (4) of the Act of 1984 (iii) Motor vehicles constructed or adapted for use for the conveyance of goods or burden the unladen weight of which does not exceed 30 cwt.	Wholly within a Parking Space except a Parking Space marked as being reserved for vehicles displaying a Blue Badge or any other Permit issued or approved by the Council	All Days All Hours	Between 09.00 – 18.00 Mondays to Sundays (including Bank or Public Holidays)	Up to 1 hour £0.80 Up to 2 hours £1.50 Up to 4 hours £2.50 All day £4.70	Up to 1 hour £1.00 Up to 2 hours £1.70 Up to 4 hours £2.70 All day £4.90
	(iv) Vehicles displaying in the relevant position a disabled person's badge	Wholly within a Parking Space except a Parking Space marked as being reserved for vehicles displaying a Permit issued or approved by the Council	All Days All Hours	Between 09.00 – 18.00 Mondays to Sundays (including Bank or Public Holidays)	Maximum stay 3 hours, no return within 1 hour No Charge	Maximum stay 3 hours, no return within 1 hour No Charge

(1) Name of Parking Place	(2) Classes of Vehicle	(3) Position in which vehicle may wait	(4) Days and Hours of operation of Parking Place	(5) Charging Hours	(6) Winter Tariff Charges (between 1 November and 28/29 February)	(7) Summer Charges (between 1 March and 31 October)
Williton Central (Williton)	(i) Motor cars within the provisions of Section 136 (2) (a) of the Act of 1984 (ii) Motor cycles as defined in Section 136 (4) of the Act of 1984 (iii) Motor vehicles constructed or adapted for use for the conveyance of goods or burden the unladen weight of which does not exceed 30 cwt.	Wholly within a Parking Space except a Parking Space marked as being reserved for vehicles displaying a Blue Badge or any other Permit issued or approved by the Council	All Days All Hours	Between 09.00 – 18.00 Mondays to Sundays (including Bank or Public Holidays)	Marked Short Stay 15 minute parking spaces, no return within 2 hours No Charge Up to 1 hour £0.80 Up to 2 hours £1.50 Up to 4 hours £2.50 All day £4.70	Marked Short Stay 15 minute parking spaces, no return within 2 hours No Charge Up to 1 hour £1.00 Up to 2 hours £1.70 Up to 4 hours £2.70 All day £4.90
	(iv) Vehicles displaying in the relevant position a disabled person's badge	Wholly within a Parking Space except a Parking Space marked as being reserved for vehicles displaying a Permit issued or approved by the Council	All Days All Hours	Between 09.00 – 18.00 Mondays to Sundays (including Bank or Public Holidays)	Maximum stay 3 hours, no return within 1 hour No Charge	Maximum stay 3 hours, no return within 1 hour No Charge
Williton Central Rear of West Somerset House	(i) Motor cars within the provisions of Section 136 (2) (a) of the Act of 1984 (ii) Motor cycles as defined in Section 136 (4) of the Act of 1984 (iii) Motor vehicles constructed or adapted for use for the conveyance of goods or burden the unladen weight of which does not exceed 30 cwt.	Wholly within a Parking Space except a Parking Space marked as being reserved for vehicles displaying a Blue Badge or any other Permit issued or approved by the Council	All Days All Hours	Between 09.00 – 18.00 Mondays to Sunday (including Bank or Public Holidays)	Staff Permits only	Staff Permits only

(1) Name of Parking Place	(2) Classes of Vehicle	(3) Position in which vehicle may wait	(4) Days and Hours of operation of Parking Place	(5) Charging Hours	(6) Winter Tariff Charges (between 1 November and 28/29 February)	(7) Summer Charges (between 1 March and 31 October)
	(iv) Vehicles displaying in the relevant position a disabled person's badge	Wholly within a Parking Space except a Parking Space marked as being reserved for vehicles displaying a Permit issued or approved by the Council	All Days All Hours	Between 09.00 – 18.00 Mondays to Sundays (including Bank or Public Holidays)	Maximum stay 3 hours, no return within 1 hour No Charge	Maximum stay 3 hours, no return within 1 hour No Charge
Anchor Street (Watchet)	(i) Motor cars within the provisions of Section 136 (2) (a) of the Act of 1984 (ii) Motor cycles as defined in Section 136 (4) of the Act of 1984 (iii) Motor vehicles constructed or adapted for use for the conveyance of goods or burden the unladen weight of which does not exceed 30 cwt.	Wholly within a Parking Space except a Parking Space marked as being reserved for vehicles displaying a Blue Badge or any other Permit issued or approved by the Council	All Days All Hours	Between 09.00 – 18.00 Mondays to Sundays (including Bank or Public Holidays)	Up to 1 hour £0.80 Up to 2 hours £1.50 Up to 4 hours £2.50 All day £4.70	Up to 1 hour £1.00 Up to 2 hours £1.70 Up to 4 hours £2.70 All day £4.90
	(iv) Vehicles displaying in the relevant position a disabled person's badge	Wholly within a Parking Space except a Parking Space marked as being reserved for vehicles displaying a Permit issued or approved by the Council	All Days All Hours	Between 09.00 – 18.00 Mondays to Sundays (including Bank or Public Holidays)	Maximum stay 3 hours, no return within 1 hour No Charge	Maximum stay 3 hours, no return within 1 hour No Charge

(1) Name of Parking Place	(2) Classes of Vehicle	(3) Position in which vehicle may wait	(4) Days and Hours of operation of Parking Place	(5) Charging Hours	(6) Winter Tariff Charges (between 1 November and 28/29 February)	(7) Summer Charges (between 1 March and 31 October)
Market Street (Watchet)	(i) Motor cars within the provisions of Section 136 (2) (a) of the Act of 1984 (ii) Motor cycles as defined in Section 136 (4) of the Act of 1984 (iii) Motor vehicles constructed or adapted for use for the conveyance of goods or burden the unladen weight of which does not exceed 30 cwt.	Wholly within a Parking Space except a Parking Space marked as being reserved for vehicles displaying a Blue Badge or any other Permit issued or approved by the Council	All Days All Hours	Between 09.00 – 18.00 Mondays to Sundays (including Bank or Public Holidays)	Up to 1 hour £0.80 Up to 2 hours £1.50 Up to 4 hours £2.50 All day £4.70	Up to 1 hour £1.00 Up to 2 hours £1.70 Up to 4 hours £2.70 All day £4.90
	(iv) Vehicles displaying in the relevant position a disabled person's badge				Maximum stay 3 hours, no return within 1 hour No Charge	Maximum stay 3 hours, no return within 1 hour No Charge
Swain Street (Watchet)	(i) Motor cars within the provisions of Section 136 (2) (a) of the Act of 1984 (ii) Motor cycles as defined in Section 136 (4) of the Act of 1984 (iii) Motor vehicles constructed or adapted for use for the conveyance of goods or burden the unladen weight of which does not exceed 30 cwt.	Wholly within a Parking Space except a Parking Space marked as being reserved for vehicles displaying a Blue Badge or any other Permit issued or approved by the Council	All Days All Hours	Between 09.00 – 18.00 Mondays to Sundays (including Bank or Public Holidays)	Marked Short Stay 15 minute parking spaces, no return within 2 hours No Charge Up to 1 hour £0.80 Up to 2 hours £1.50 Up to 4 hours £2.50 All day £4.70	Marked Short Stay 15 minute parking spaces, no return within 2 hours No Charge Up to 1 hour £1.00 Up to 2 hours £1.70 Up to 4 hours £2.70 All day £4.90

(1) Name of Parking Place	(2) Classes of Vehicle	(3) Position in which vehicle may wait	(4) Days and Hours of operation of Parking Place	(5) Charging Hours	(6) Winter Tariff Charges (between 1 November and 28/29 February)	(7) Summer Charges (between 1 March and 31 October)
	(iv) Vehicles displaying in the relevant position a disabled person's badge	Wholly within a Parking Space except a Parking Space marked as being reserved for vehicles displaying a Permit issued or approved by the Council	All Days All Hours	Between 09.00 – 18.00 Mondays to Sundays (including Bank or Public Holidays)	Maximum stay 3 hours, no return within 1 hour No Charge	Maximum stay 3 hours, no return within 1 hour No Charge
Harbour Road (Watchet)	(i) Motor cars within the provisions of Section 136 (2) (a) of the Act of 1984	Wholly within a Parking Space except a Parking Space marked as being reserved for vehicles displaying a Blue Badge or any other Permit issued or approved by the Council	All Days All Hours	Between 09.00 – 18.00 Mondays to Sundays (including Bank or Public Holidays)	Up to 1 hour £0.80 Up to 2 hours £1.50 Up to 4 hours £2.50 All day £4.70	Up to 1 hour £1.00 Up to 2 hours £1.70 Up to 4 hours £2.70 All day £4.90
	(ii) Motor cycles as defined in Section 136 (4) of the Act of 1984					
	(iii) Motor vehicles constructed or adapted for use for the conveyance of goods or burden the unladen weight of which does not exceed 30 cwt.					
	(iv) Vehicles displaying in the relevant position a disabled person's badge	Wholly within a Parking Space except a Parking Space marked as being reserved for vehicles displaying a Permit issued or approved by the Council	All Days All Hours	Between 09.00 – 18.00 Mondays to Sundays (including Bank or Public Holidays)	Maximum stay 3 hours, no return within 1 hour No Charge	Maximum stay 3 hours, no return within 1 hour No Charge

(1) Name of Parking Place	(2) Classes of Vehicle	(3) Position in which vehicle may wait	(4) Days and Hours of operation of Parking Place	(5) Charging Hours	(6) Winter Tariff Charges (between 1 November and 28/29 February)	(7) Summer Charges (between 1 March and 31 October)
West Pier (Watchet)	(i) Motor cars within the provisions of Section 136 (2) (a) of the Act of 1984 (ii) Motor cycles as defined in Section 136 (4) of the Act of 1984 (iii) Motor vehicles constructed or adapted for use for the conveyance of goods or burden the unladen weight of which does not exceed 30 cwt.	Wholly within a Parking Space except a Parking Space marked as being reserved for vehicles displaying a Blue Badge or any other Permit issued or approved by the Council	All Days All Hours	Between 09.00 – 18.00 Mondays to Sundays (including Bank or Public Holidays)	Up to 1 hour £0.80 Up to 2 hours £1.50 Up to 4 hours £2.50 All day £4.70	Up to 1 hour £1.00 Up to 2 hours £1.70 Up to 4 hours £2.70 All day £4.90
	(iv) Vehicles displaying in the relevant position a disabled person's badge				Maximum stay 3 hours, no return within 1 hour No Charge	Maximum stay 3 hours, no return within 1 hour No Charge
Mart Road Coach Park (Minehead)	(i) Coaches within the provision of Section 1 of the Public Passenger Vehicles Act 1981 and not being used to provide a local service	Wholly within a Parking Space.	All Days All Hours	Not applicable	No Charge	No Charge

(1) Name of Parking Place	(2) Classes of Vehicle	(3) Position in which vehicle may wait	(4) Days and Hours of operation of Parking Place	(5) Charging Hours	(6) Winter Tariff Charges (between 1 November and 28/29 February)	(7) Summer Charges (between 1 March and 31 October)
Exmoor House (Dulverton)	(i) Motor cars within the provisions of Section 136 (2) (a) of the Act of 1984 (ii) Motor cycles as defined in Section 136 (4) of the Act of 1984 (iii) Motor vehicles constructed or adapted for use for the conveyance of goods or burden the unladen weight of which does not exceed 30 cwt.	Wholly within a Parking Space except a Parking Space marked as being reserved for vehicles displaying a Blue Badge or any other Permit issued or approved by the Council	All Days All Hours	Between 09.00 – 18.00 Mondays to Sundays (including Bank or Public Holidays)	Up to 2 hours £1.00 Up to 3 hours £1.50 All day £4.50	Up to 2 hours £1.00 Up to 3 hours £1.50 All Day £4.50
	(iv) Vehicles displaying in the relevant position a disabled person's badge				Maximum stay 3 hours, no return within 1 hour No Charge	Maximum stay 3 hours, no return within 1 hour No Charge
Lion Stables (Dulverton)	(i) Motor cars within the provisions of Section 136 (2) (a) of the Act of 1984	Wholly within a Parking Space except a Parking Space marked as being reserved for vehicles displaying a Blue Badge or any other Permit issued or approved by the Council	All Days All Hours	Between 09.00 – 18.00 Mondays to Sundays (including Bank or Public Holidays)	Maximum stay 3 hours, no return within 1 hour	Maximum stay 3 hours, no return within 1 hour
	(ii) Motor cycles as defined in Section 136 (4) of the Act of 1984				Up to 1 hour £0.50 Up to 2 hours £1.00 Up to 3 hours £1.50	Up to 1 hour £0.50 Up to 2 hours £1.00 Up to 3 hours £1.50
	(iii) Motor vehicles constructed or adapted for use for the conveyance of goods or burden the unladen weight of which does not exceed 30 cwt.					

(1) Name of Parking Place	(2) Classes of Vehicle	(3) Position in which vehicle may wait	(4) Days and Hours of operation of Parking Place	(5) Charging Hours	(6) Winter Tariff Charges (between 1 November and 28/29 February)	(7) Summer Charges (between 1 March and 31 October)
	(iv) Vehicles displaying in the relevant position a disabled person's badge	Wholly within a Parking Space except a Parking Space marked as being reserved for vehicles displaying a Permit issued or approved by the Council	All Days All Hours	Between 09.00 – 18.00 Mondays to Sundays (including Bank or Public Holidays)	Maximum stay 3 hours, no return within 1 hour No Charge	Maximum stay 3 hours, no return within 1 hour No Charge
Guildhall (Dulverton)	(i) Motor cars within the provisions of Section 136 (2) (a) of the Act of 1984	Wholly within a Parking Space except a Parking Space marked as being reserved for vehicles displaying a Blue Badge or any other Permit issued or approved by the Council	All Days All Hours	Between 09.00 – 18.00 Mondays to Sundays (including Bank or Public Holidays)	Up to 2 hours £1.00 Up to 3 hours £1.50 All day £4.50	Up to 2 hours £1.00 Up to 3 hours £1.50 All day £4.50
	(ii) Motor cycles as defined in Section 136 (4) of the Act of 1984					
	(iii) Motor vehicles constructed or adapted for use for the conveyance of goods or burden the unladen weight of which does not exceed 30 cwt.					
	(iv) Vehicles displaying in the relevant position a disabled person's badge	Wholly within a Parking Space except a Parking Space marked as being reserved for vehicles displaying a Permit issued or approved by the Council	All Days All Hours	Between 09.00 – 18.00 Mondays to Sundays (including Bank or Public Holidays)	No Charge	No Charge

(1) Name of Parking Place	(2) Classes of Vehicle	(3) Position in which vehicle may wait	(4) Days and Hours of operation of Parking Place	(5) Charging Hours	(6) Winter Tariff Charges (between 1 November and 28/29 February)	(7) Summer Charges (between 1 March and 31 October)
Blue Anchor Sea Front (Blue Anchor)	(i) Motor cars within the provisions of Section 136 (2) (a) of the Act of 1984 (ii) Motor cycles as defined in Section 136 (4) of the Act of 1984 (iii) Motor vehicles constructed or adapted for use for the conveyance of goods or burden the unladen weight of which does not exceed 30 cwt.	Wholly within a Parking Space except a Parking Space marked as being reserved for vehicles displaying a Blue Badge or any other Permit issued or approved by the Council	All Days All Hours	Not Applicable	No Charge	No Charge
	(iv) Vehicles displaying in the relevant position a disabled person's badge	Wholly within a Parking Space except a Parking Space marked as being reserved for vehicles displaying a Permit issued or approved by the Council	All Days All Hours	Not Applicable	No Charge	No Charge
Crowcombe (Adjacent to Church House, Crowcombe)	(i) Motor cars within the provisions of Section 136 (2) (a) of the Act of 1984 (ii) Motor cycles as defined in Section 136 (4) of the Act of 1984 (iii) Motor vehicles constructed or adapted for use for the conveyance of goods or burden the unladen weight of which does not exceed 30 cwt.	Wholly within a Parking Space except a Parking Space marked as being reserved for vehicles displaying a Blue Badge or any other Permit issued or approved by the Council	All Days All Hours	Not Applicable	No Charge	No Charge

(1) Name of Parking Place	(2) Classes of Vehicle	(3) Position in which vehicle may wait	(4) Days and Hours of operation of Parking Place	(5) Charging Hours	(6) Winter Tariff Charges (between 1 November and 28/29 February)	(7) Summer Charges (between 1 March and 31 October)
	(iv) Vehicles displaying in the relevant position a disabled person's badge	Wholly within a Parking Space except a Parking Space marked as being reserved for vehicles displaying a Permit issued or approved by the Council	All Days All Hours	Not Applicable	No Charge	No Charge
Kilve Village (Adjacent to Village Hall, Kilve)	(i) Motor cars within the provisions of Section 136 (2) (a) of the Act of 1984	Wholly within a Parking Space except a Parking Space marked as being reserved for vehicles displaying a Blue Badge or any other Permit issued or approved by the Council	All Days All Hours	Not Applicable	No Charge	No Charge
	(ii) Motor cycles as defined in Section 136 (4) of the Act of 1984					
	(iii) Motor vehicles constructed or adapted for use for the conveyance of goods or burden the unladen weight of which does not exceed 30 cwt.					
	(iv) Vehicles displaying in the relevant position a disabled person's badge	Wholly within a Parking Space except a Parking Space marked as being reserved for vehicles displaying a Permit issued or approved by the Council	All Days All Hours	Not Applicable	No Charge	No Charge

(1) Name of Parking Place	(2) Classes of Vehicle	(3) Position in which vehicle may wait	(4) Days and Hours of operation of Parking Place	(5) Charging Hours	(6) Winter Tariff Charges (between 1 November and 28/29 February)	(7) Summer Charges (between 1 March and 31 October)
Wheddon Cross	(i) Motor cars within the provisions of Section 136 (2) (a) of the Act of 1984 (ii) Motor cycles as defined in Section 136 (4) of the Act of 1984 (iii) Motor vehicles constructed or adapted for use for the conveyance of goods or burden the unladen weight of which does not exceed 30 cwt.	Wholly within a Parking Space except a Parking Space marked as being reserved for vehicles displaying a Blue Badge or any other Permit issued or approved by the Council	All Days All Hours	Not Applicable	No Charge	No Charge
	(iv) Vehicles displaying in the relevant position a disabled person's badge	Wholly within a Parking Space except a Parking Space marked as being reserved for vehicles displaying a Permit issued or approved by the Council	All Days All Hours	Not Applicable	No Charge	No Charge

THE WEST SOMERSET DISTRICT COUNCIL (OFF STREET PARKING PLACES) ORDER 2015
SCHEDULE 2 –PERMITS AND OTHER CHARGES

- 1 For a specific Parking Place or for specific Parking Places Parking, permits are available from the Council at the appropriate fee as shown in this Schedule 2, subject to terms and conditions determined by the Council.
- 2 Parking Places and Parking Permits shall only be used as set out by The Council's terms, conditions and policies.
- 3 A Parking Permit is only valid in the Parking Place or specific Parking Places in respect of which it was issued and up to the date of expiry shown on the Parking Permits.
- 4 A Parking Permit remains the property of the Council and must be surrendered on request. In such instances where a refund fee is deemed appropriate by the Council, this will be provided in accordance with the Council's policies.
- 5 The Council may, by notice in writing served on the permit holder at the address shown by that person on the application for the permit or at any other address believed to be that person's residence or place of business, withdraw a permit if it appears to the Council that any of the stipulated terms and conditions have been abused and the permit will immediately become invalid.
- 6 Permits are not valid in any limited waiting bay, disabled or restricted parking bays.

Permit Cost and Specified Car Parks

Permit Type	Period	Cost per permit	Specified Car Parks
Named	6 months 12 months	£110.00 £150.00	Minehead - Alexandra Road; North Road; Clanville; Quay West, Warren Road Upper. Porlock - Central. Dunster - Park Street; Dunster Steep. Watchet - Anchor Street; Market Street; Swain Street; Harbour Road, West Pier. Williton - Central
District	6 months 12 months	£160.00 £250.00	Minehead - Alexandra Road; North Road; Clanville; Quay West, Warren Road Upper. Porlock - Central. Dunster - Park Street; Dunster Steep. Watchet - Anchor Street; Market Street; Swain Street; Harbour Road, West Pier. Williton - Central Dulverton - Lion Stables; Exmoor House; Guildhall.
Business	6 months 12 months	£200.00 £320.00	Minehead - Alexandra Road; North Road; Clanville; Quay West, Warren Road Upper. Porlock - Central. Dunster - Park Street; Dunster Steep. Watchet - Anchor Street; Market Street; Swain Street; Harbour Road, West Pier. Williton - Central Dulverton - Lion Stables; Exmoor House; Guildhall.
Before 10.00am	6 months	£25.00	Minehead - Alexandra Road; North Road; Clanville; Quay West, Warren Road Upper. Porlock - Central. Dunster - Park Street; Dunster Steep. Watchet - Anchor Street; Market Street; Swain Street; Harbour Road, West Pier. Williton - Central

Permit Type	Period	Cost per permit	Specified Car Parks
			Dulverton - Lion Stables; Exmoor House; Guildhall.
Weekly	Weekly	£25.00	Minehead - Alexandra Road; North Road; Clanville; Quay West, Warren Road Upper. Porlock - Central. Dunster - Park Street; Dunster Steep. Watchet - Anchor Street; Market Street; Swain Street; Harbour Road, West Pier. Williton - Central
Shoppers	12 months	£35.00	Minehead - Alexandra Road; North Road; Clanville; Quay West; Warren Road Upper. Porlock - Central. Dunster - Dunster Steep. Watchet - Anchor Street; Market Street; West Pier. Williton - Central
Dulverton	Weekly 6 months 12 months	£20.00 £45.00 £80.00	Dulverton - Lion Stables; Exmoor House; Guildhall.
Parson Street	12 months	£150.00	Porlock - Parson Street (allocated bay).

THE WEST SOMERSET DISTRICT COUNCIL (OFF STREET PARKING PLACES) ORDER 2015
SCHEDULE 3 – PENALTY CHARGES

1	2	3	4	5	6
Higher Level Penalty Charge	Lower Level Penalty charge	Higher Level (Paid within 14 days)	Lower Level (Paid within 14 days)	Higher Level (After service of charge certificate)	Lower Level (After service of charge certificate)
£70.00	£50.00	£35.00	£25.00	£105.00	£75.00

THE WEST SOMERSET DISTRICT COUNCIL (OFF STREET PARKING PLACES) ORDER 2015
SCHEDULE 4 – MAPS

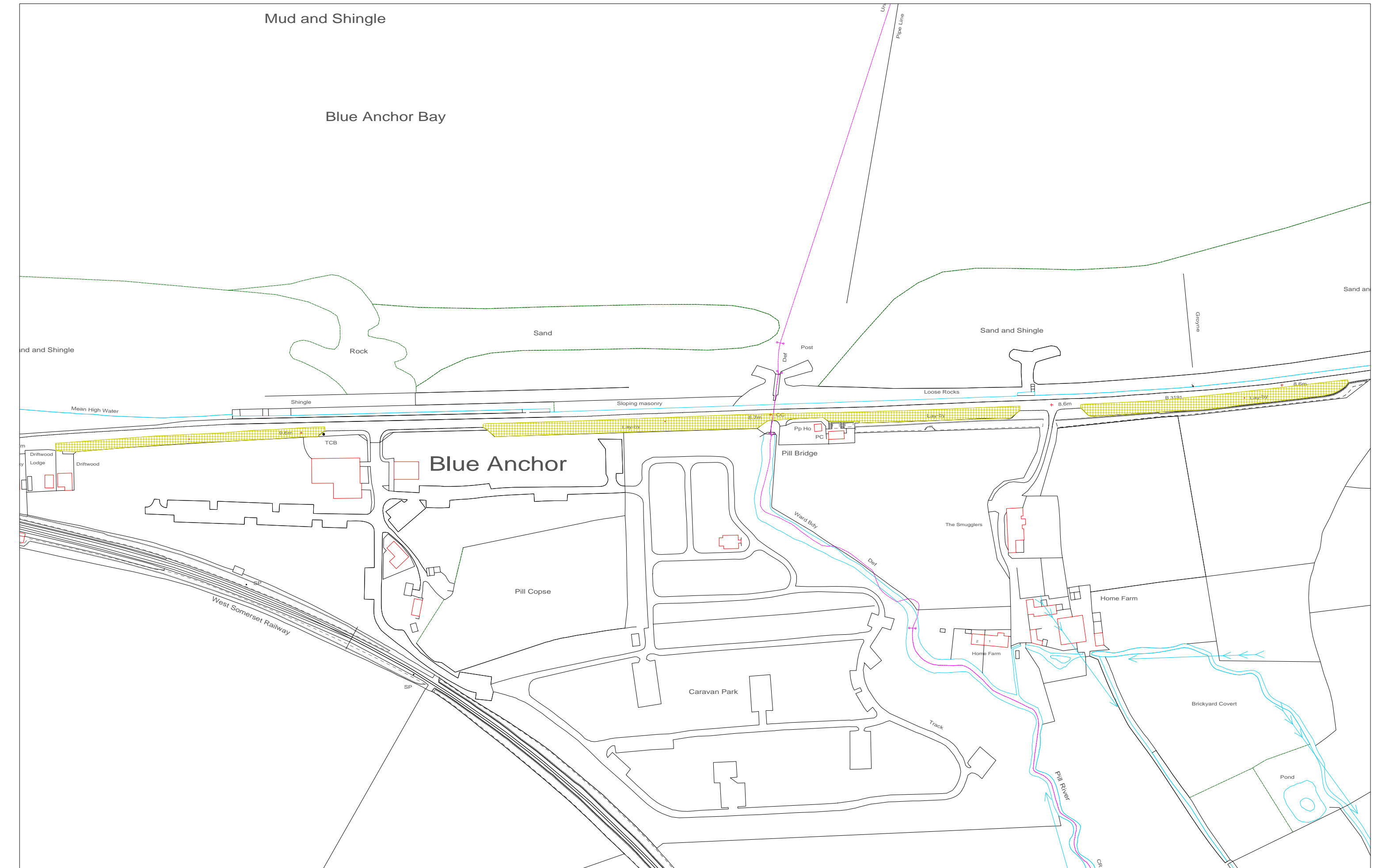

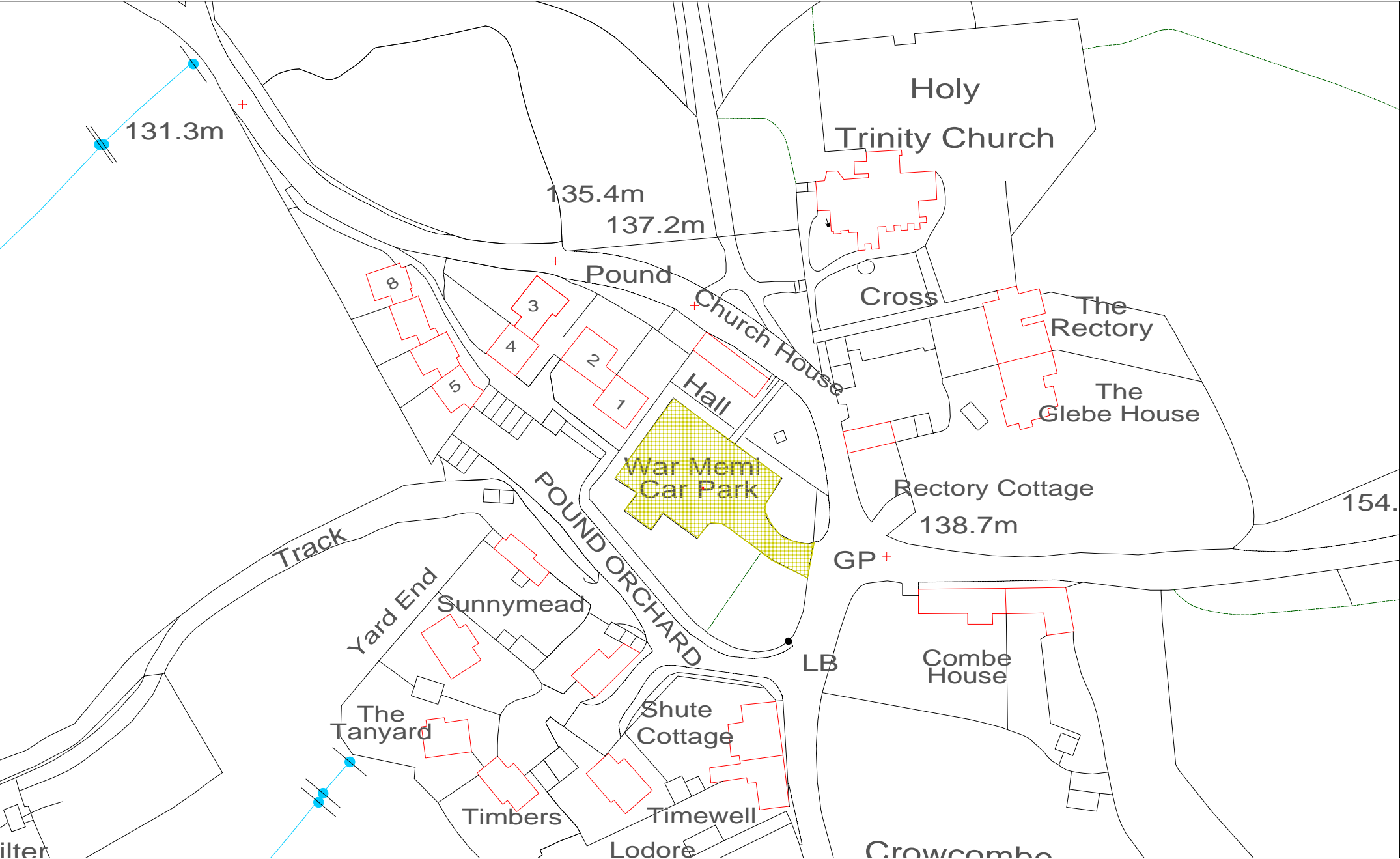

WEST SOMERSET COUNCIL

This copy has been produced specifically for External Use Only

Map of Dulverton Car Parks

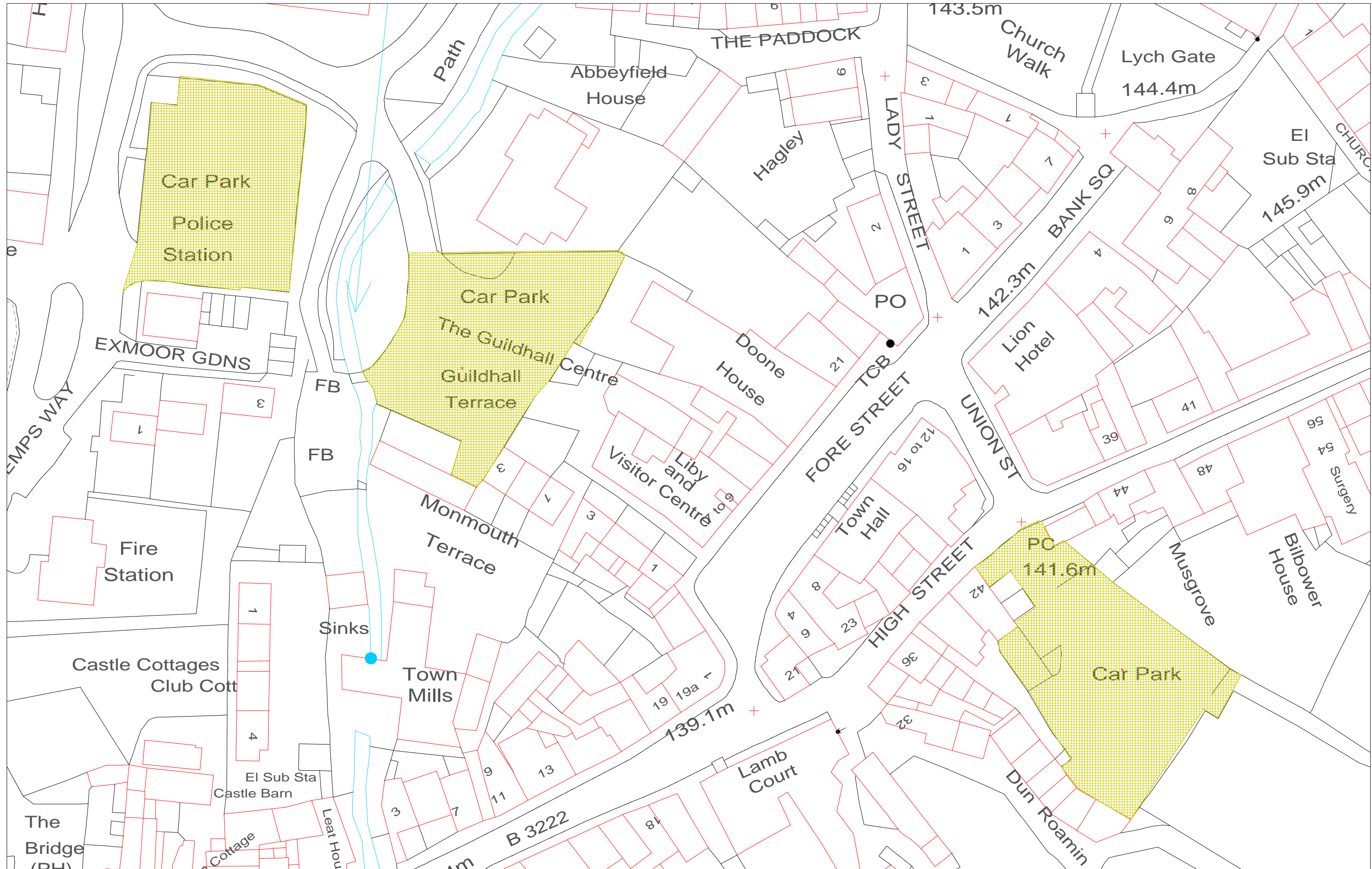

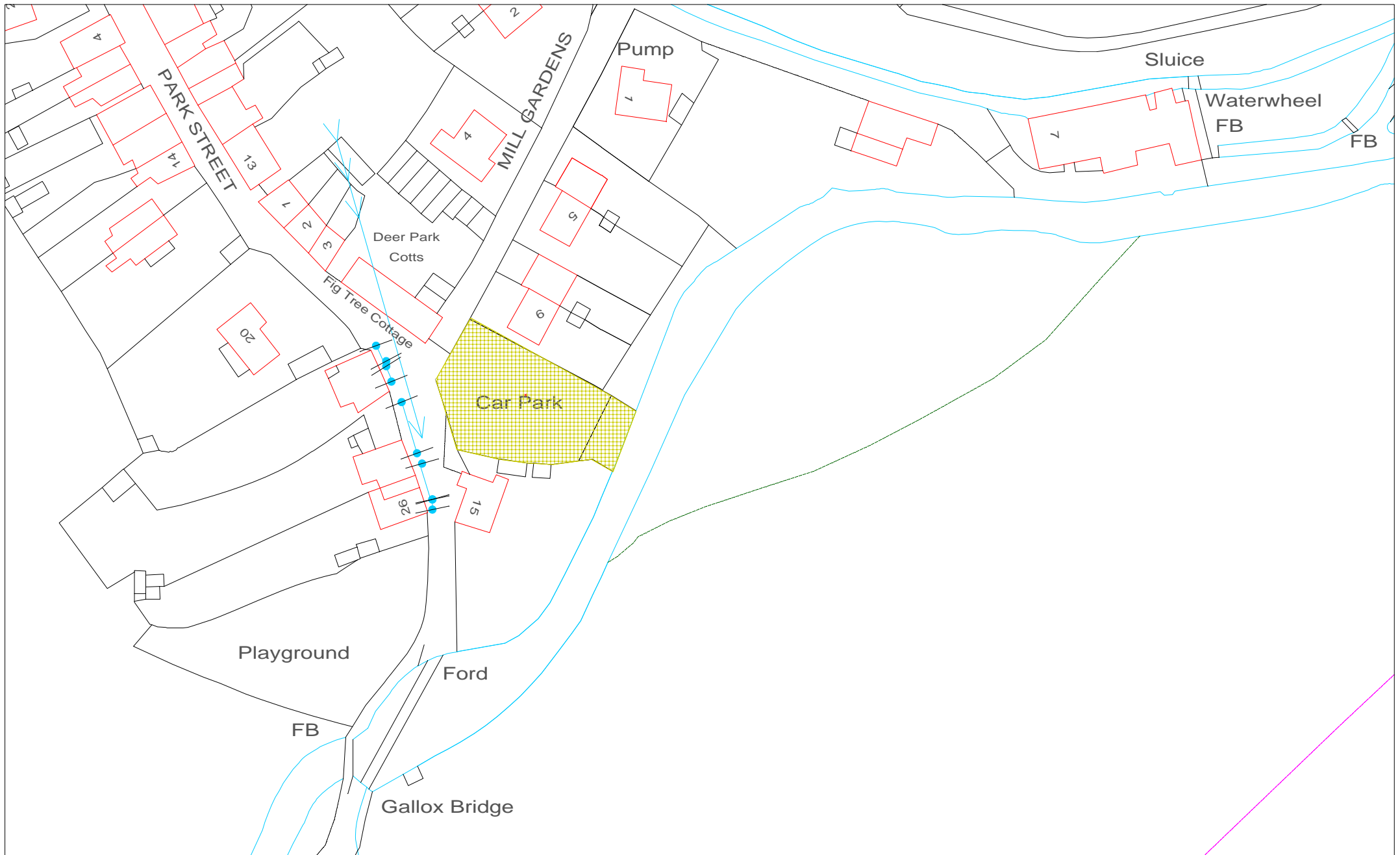



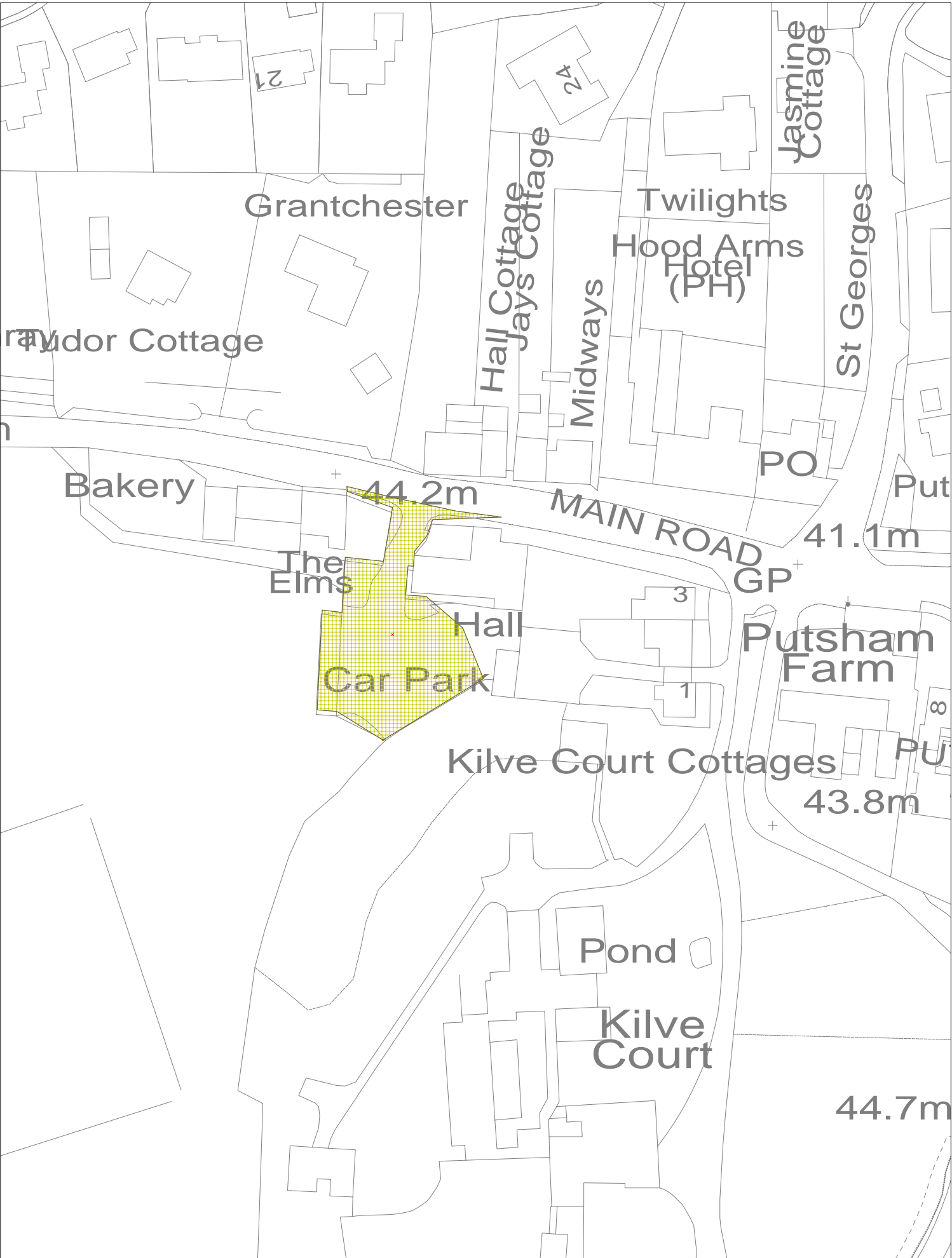



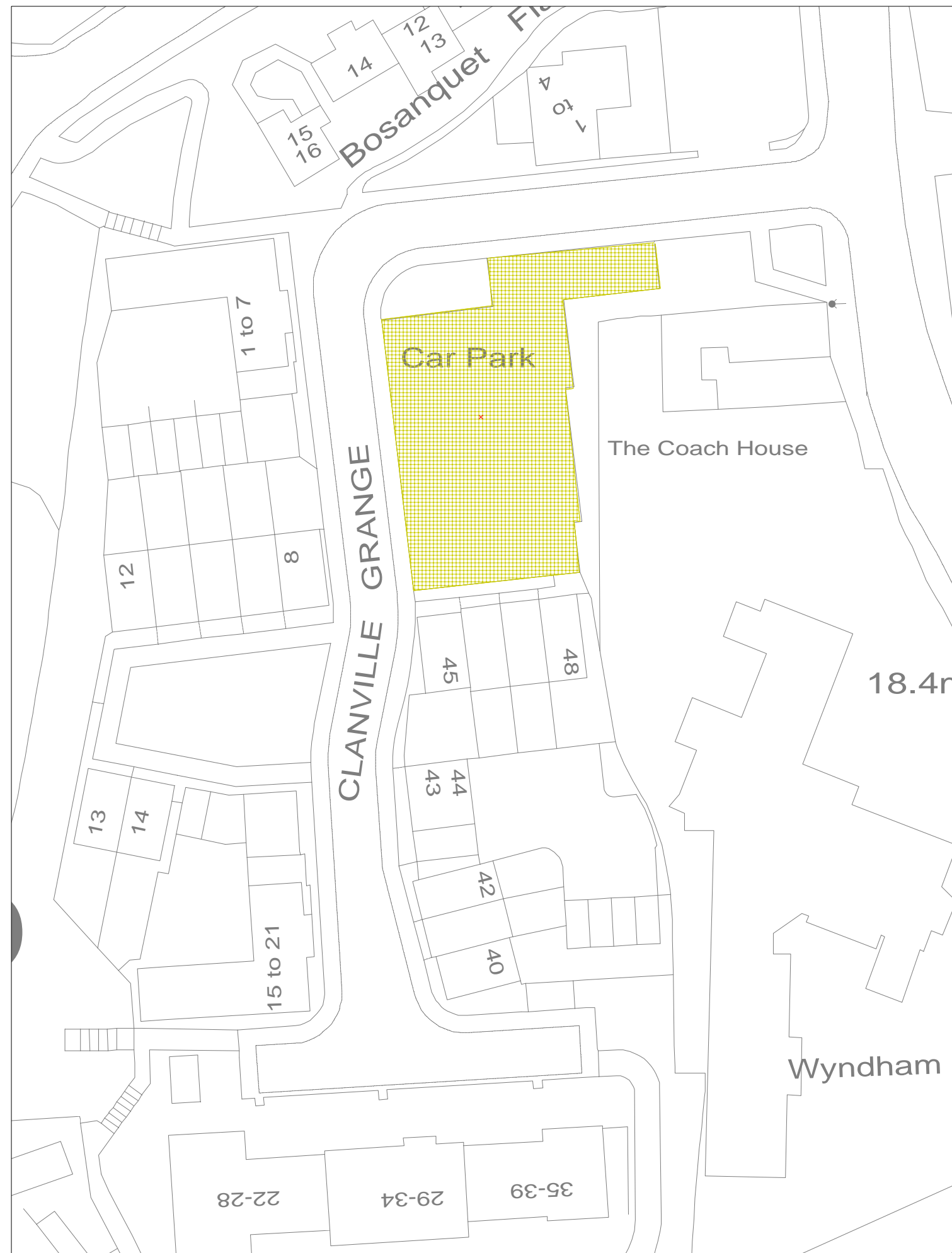

WEST SOMERSET COUNCIL

Reproduced from the Ordnance Survey with the permission of the Controller of Her Majesty's Stationery Office © Crown Copyright. Unauthorised reproduction infringes Crown copyright and may lead to prosecution or civil proceedings.

This copy has been produced specifically for Internal Use Only.
No further copies may be made.



— Coach Park

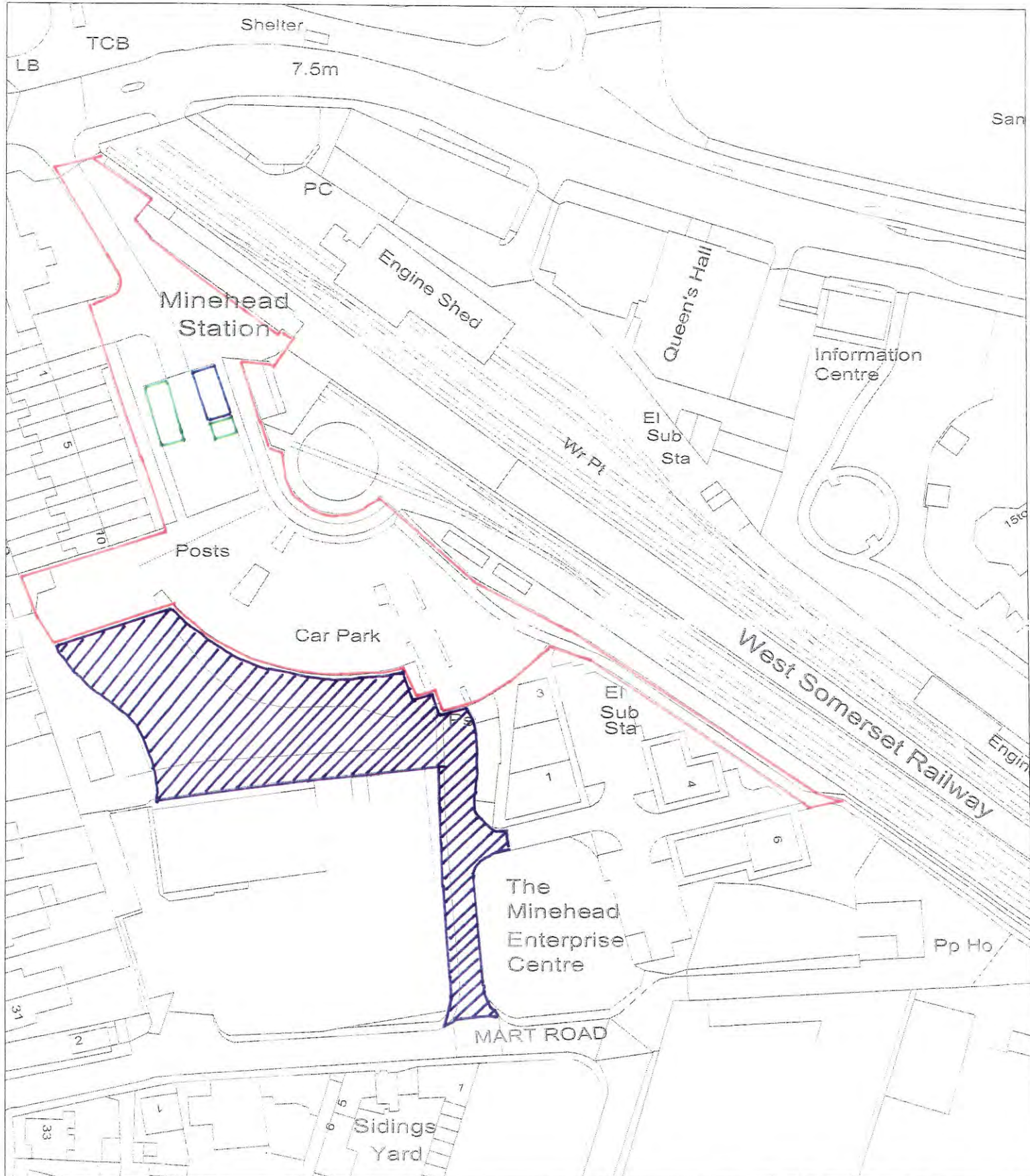





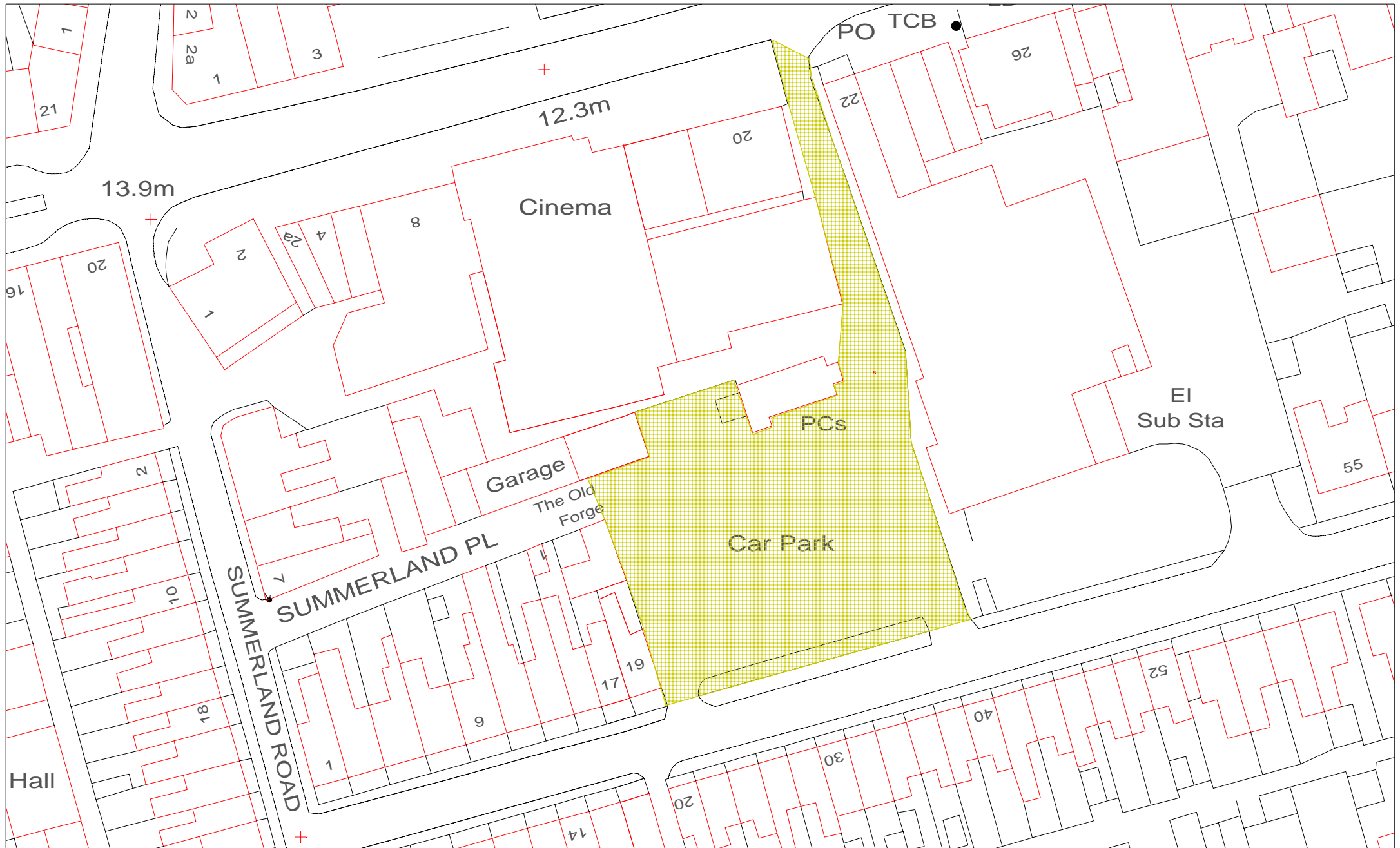



WEST SOMERSET COUNCIL

This copy has been produced specifically for External Use Only.

Map of Porlock Doverhay Car park

